

A  
B  
C  
D  
E  
F

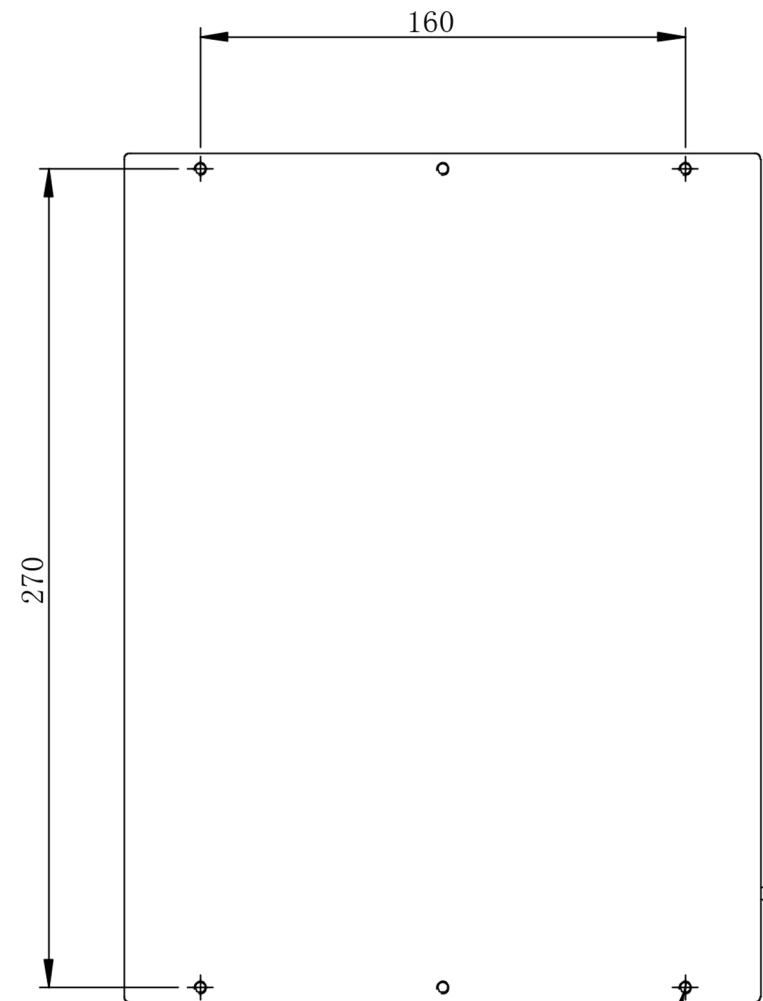
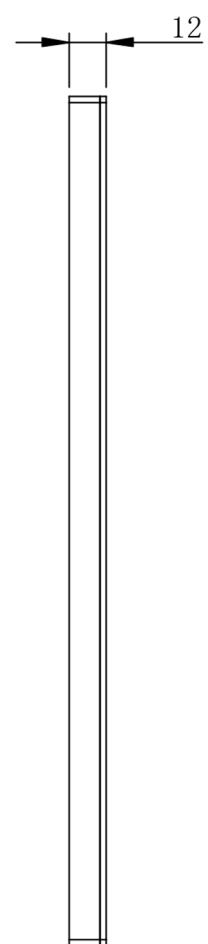
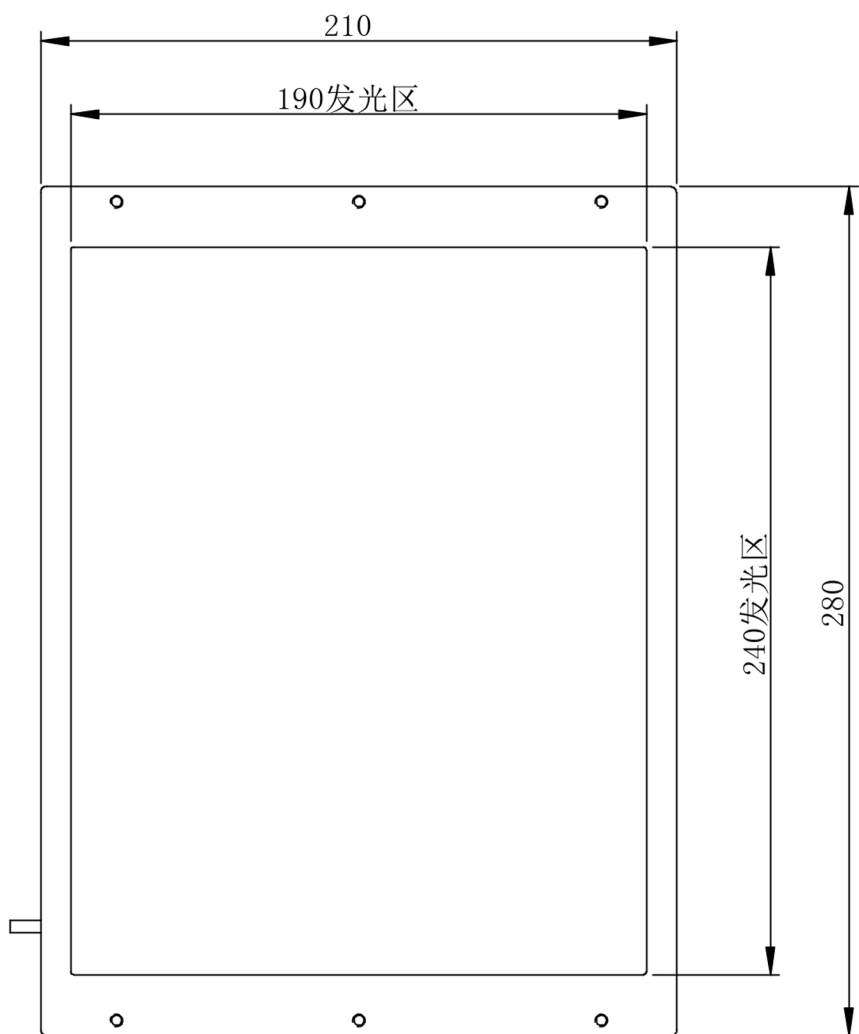

出线长度800mm

6 x M4 - 6H 完全贯穿  
Φ 3.30 完全贯穿

Details of Connector

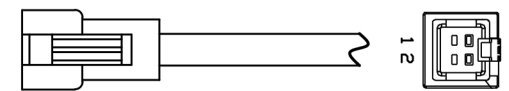

Pin1: - (Blue)  
Pin2: + (Red)

Connector Type: SMR-03V-B (Light Side)  
SMP-03V-BC (Power Supply Side)

Specification:

MODEL	PL-CBO280210-W/-B/-G/-UV	-R/-IR850/-IR940
Wavelength (nm)	6500K/470/530/385	625/850/940
Power Supply	DC24V/7.8 (W)	DC24V/7 (W)

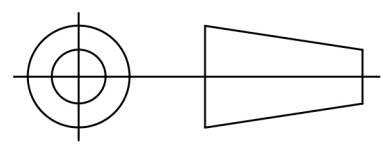

Itemref	Quantity	Material: AL/ACRIL	ArticleNo./Reference
			Filename PL-CBO280210
			Scale 1/1
<b>PL-CBO280210-U</b>			
PL-CBO280210-0000			Edition VER.1.0
			Sheet 1