

Details of Connector

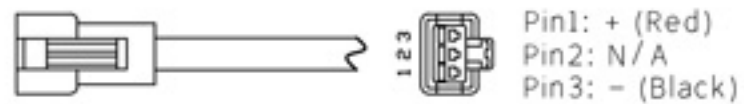

Connector Type: SMR-03V-B (Light Side)
SMP-03V-BC (Power Supply Side)

Specification:

MODEL	YL-RIH100-4-W/-UV/-B/-G/-Y/-R/-IR850/-IR940
Wavelength (nm)	6500K (Color temperature) / 390/470/525/625/850/940
Power Supply	DC24V/7.5 (W)

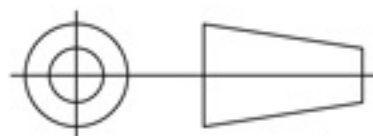

Itemref	Quantity	Material: AL/ACRIL	ArticleNo./Reference	
			Filename YL-RIH100	Scale 1/1
			YL-RIH100	
			YL-RIH100-0000	Edition VER.10 Sheet 1