

M3 - 6H ∇ 6
 ϕ 2.50 ∇ 8.50
 两侧对称

光源线长1000mm

Details of Connector

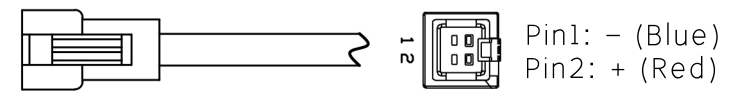

Connector Type: SMR-03V-B (Light Side)
 SMP-03V-BC (Power Supply Side)

Specification:

MODEL	PL-GTR9528-W/-B/-G/-UV	-R/-IR850/-IR940
Wavelength (nm)	6500K/470/530/385	625/850/940
Power Supply	DC24V/2.1 (W)	DC24V/2.1 (W)

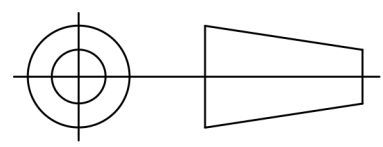

Itemref	Quantity	Material: AL/ACRIL	ArticleNo./Reference
			Filename PL-GTR9528
			Scale 1/1
PL-GTR9528-U			
PL-GTR9528-0000			Edition VER.1.0
			Sheet 1